

NO.	ECN NO.	DESCRIPTION	REV.	DRAW	DATE
1					
2					
3					

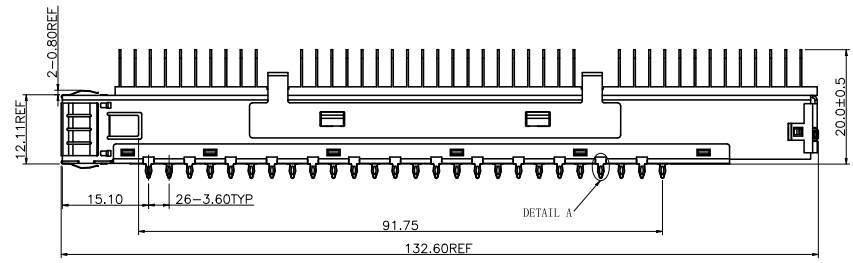

插入光模块后
顶高 0.80mm MAX

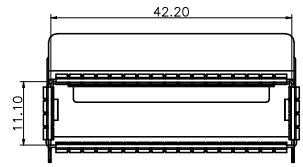
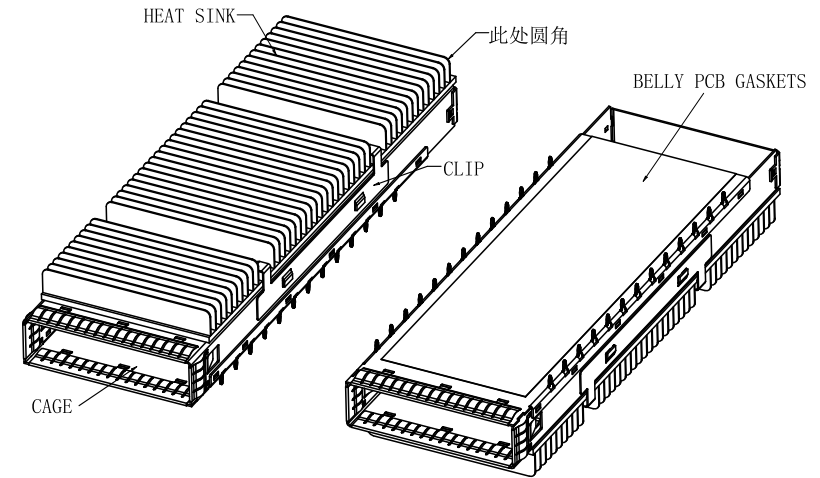
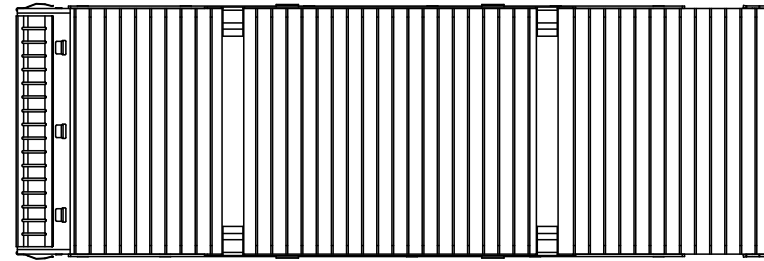
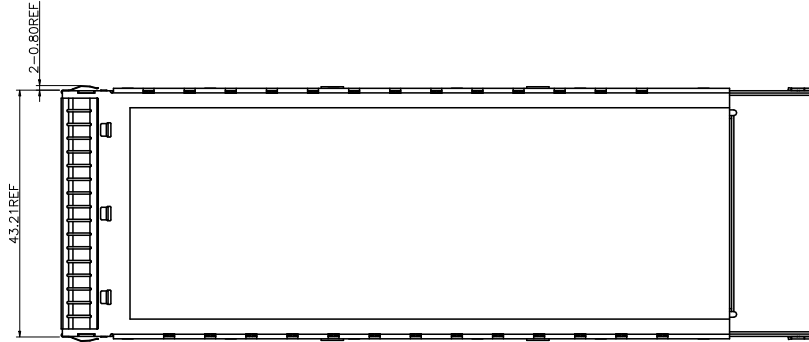
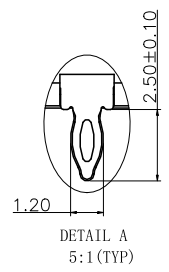

- NOTES:
1. CAGE: COPPER ALLOY
 2. HEAT SINK: COPPER
 3. CLIP: STAINLESS STEEL.

产品客户图 Customer Drw		
未注公差 TOLERANCE	. X	±0.35
UNLESS OTHERWISE SPECIFIED	. XX	±0.25
	. XXX	±0.15
	X. °	±2°

GLGNET® 深圳市方向电子股份有限公司
SHEN ZHEN GLGNET ELECTRONICS CO.,LTD.

比例 SCALE	1:1	角法 PROJ.	第一角法	设计 DESIGN		品名 TITLE	CFP2 1x1-A0 WITH HEAT SINK
张数 SHEET	1/3	大小 SIZE	A4	校对 CHECKED		料号 ITEM NO.	36001-00N011
单位 UNIT	mm	版本 REV.	A0	核准 APPROVED		图号 DWG NO.	GLG-WS-345

NO.	ECN NO.	DESCRIPTION	REV.	DRAW	DATE
1					
2					
3					

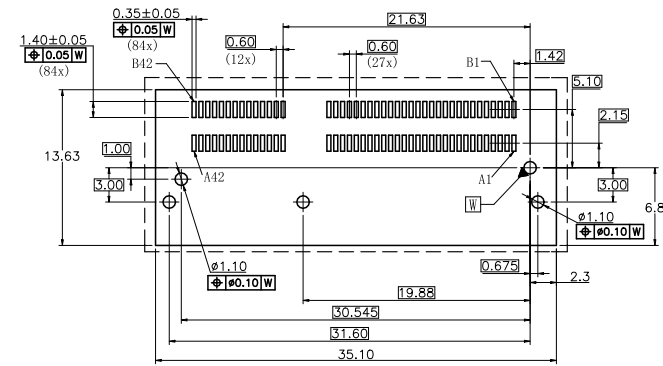
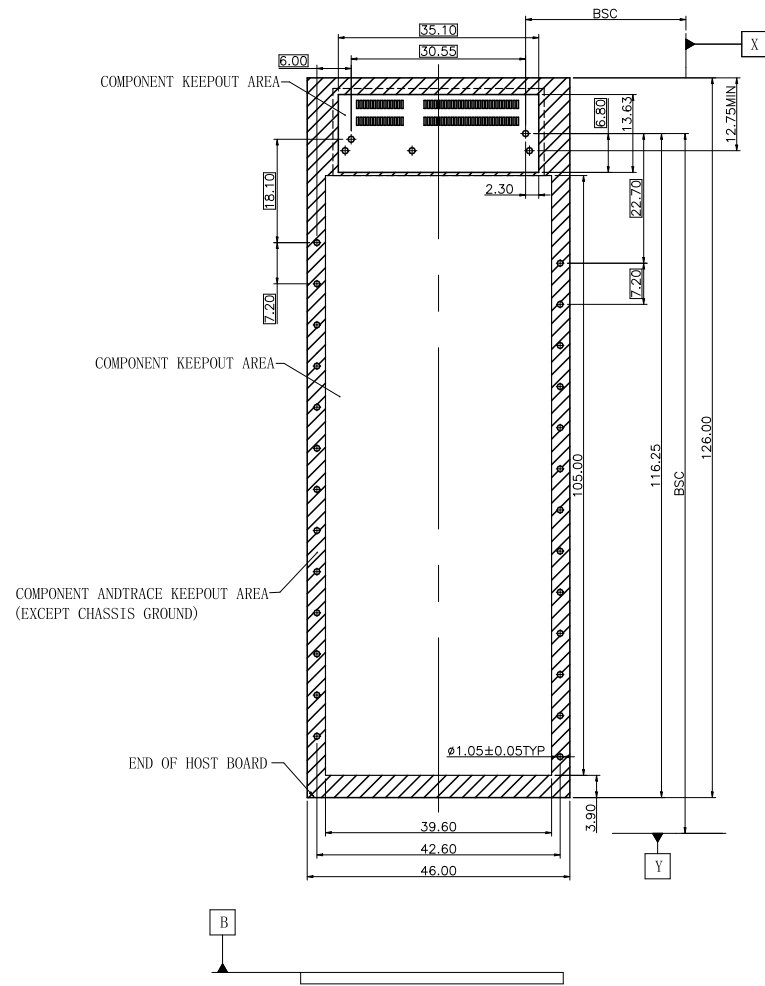

SCALE 2:1

RECOMMENDED PCB LAYOUT (COMPONENT SIDE)
 RECOMMENDED MINIMUM PCB THICKNESS: 1.80mm
 (ALL TOLERANCES ARE ± 0.05)
 RECOMMENDED PCB CONFIGURATION WITH KEEP-OUT
 AREAS SINGLE SIDED APPLICATIONS

产品客户图 Customer Draw		GLGNET® 深圳市方向电子股份有限公司 SHEN ZHEN GLGNET ELECTRONICS CO., LTD.	
未注公差 TOLERANCE UNLESS OTHERWISE SPECIFIED	.X .XX .XXX X.°	± 0.35 ± 0.25 ± 0.15 $\pm 2^\circ$	
比例 SCALE	1:1	角法 PROJ.	设计 DESIGN
张数 SHEET	2/3	大小 SIZE	校对 CHECKED
单位 UNIT	mm	版本 REV.	核准 APPROVED
		品名 TITLE	CFP2 1x1-A0 WITH HEAT SINK
		料号 ITEM NO.	36001-00N011
		图号 DWG NO.	GLG-WS-345

NO.	ECN NO.	DESCRIPTION	REV.	DRAW	DATE
1					
2					
3					

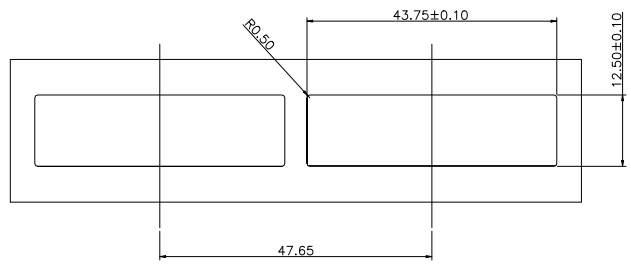

RECOMMENDED PANEL CUTOUT AND PC BOARD
 PANEL POSITION AND THICKNESS 0.8-2.6

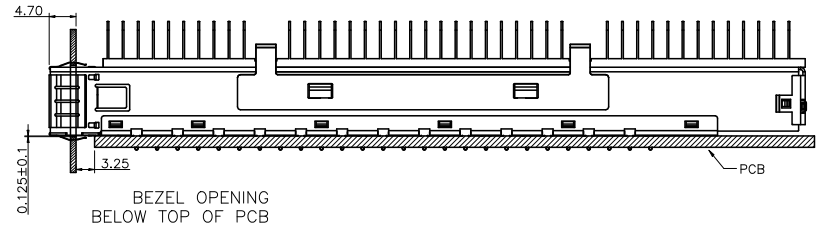
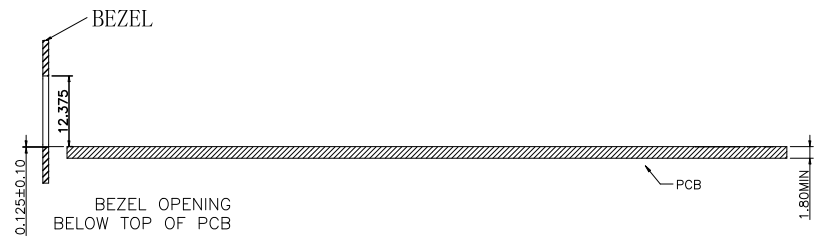

产品客户图 Customer Drw		
未注公差 TOLERANCE	.X	±0.35
UNLESS OTHERWISE SPECIFIED	.XX	±0.25
	.XXX	±0.15
	X.°	±2°

GLGNET® 深圳市方向电子股份有限公司
 SHEN ZHEN GLGNET ELECTRONICS CO.,LTD.

比例 SCALE	1:1	角法 PROJ.	第一角法	设计 DESIGN		品名 TITLE	CFP2 1x1-A0 WITH HEAT SINK
张数 SHEET	3/3	大小 SIZE	A4	校对 CHECKED		料号 ITEM NO.	36001-00N011
单位 UNIT	mm	版本 REV.	A0	核准 APPROVED		图号 DWG NO.	GLG-WS-345