

NO.	ECN NO.	DESCRIPTION	REV.	DRAW	DATE
1					
2					
3					

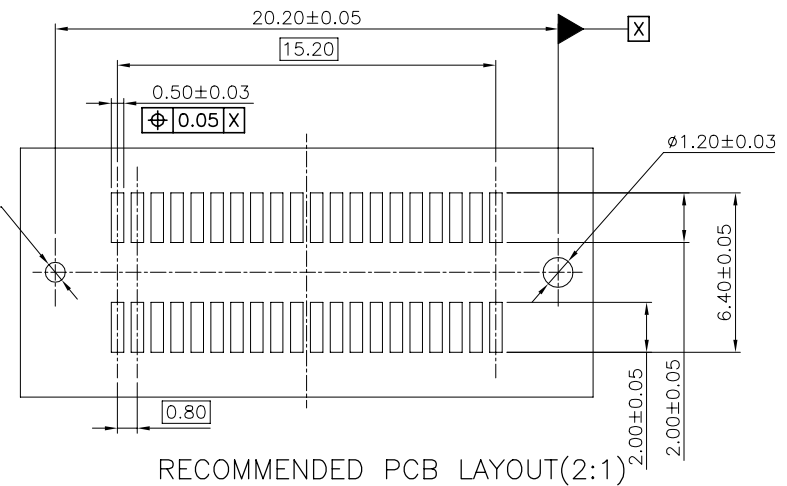

喷字 (是否喷码见客户包规):
DATE CODE:YYWWD

YY=年(两位, 如2020年就取数字20)
WW=1年中的第几周(两位)
D=1周中的星期几(一位)

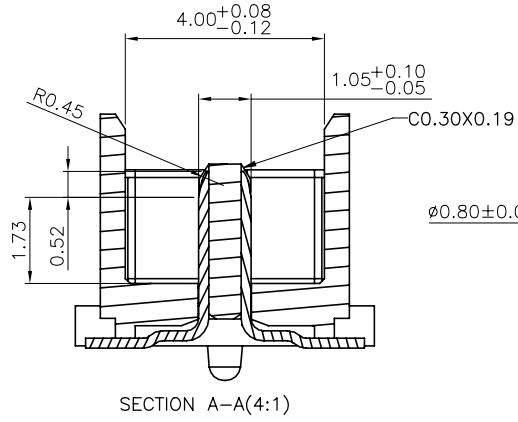
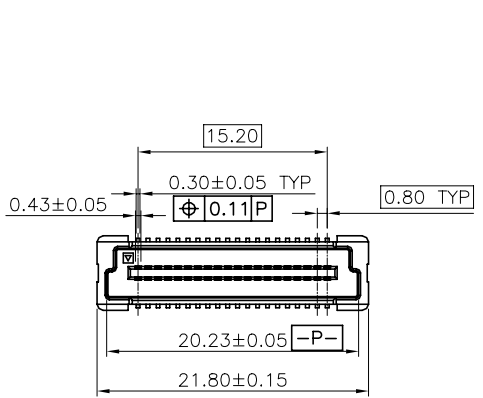
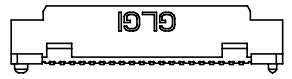
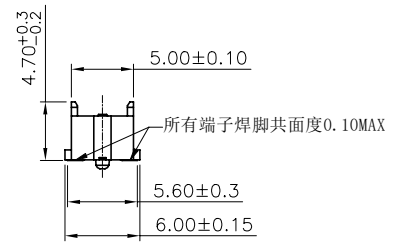
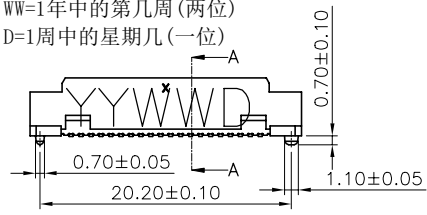

RECOMMENDED PCB LAYOUT TOLERANCE:±0.05mm

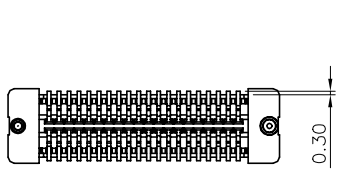
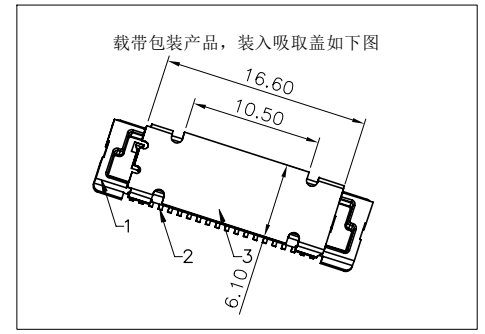

16005-XXXXX1
成品识别码
M17: Ni50-100u", Au8u", Brume Sn80-120u"
M19: Ni50-100u", Au15u", Brume Sn80-120u"
M23: Ni50-100u", Au30u", Brume Sn80-120u"
规格流水码

- NOTES:
- HOUSING: LCP UL94V-0, NATURAL.
 - CONTACT: COPPER ALLOY.
 - PICK UP: STAINLESS STEEL.
 - THE HOUSING WITH WITHSTAND EXPOSURE UP TO 260° PEAK TEMPERATURE FOR 30 SECONDS IN A CONVECTION, INFRA-RED OR VAPOR REFLOW OVEN.
 - ▲DENOTES CRITICAL DIMENSION.
 - Operating Temperature (工作温度): -40 °C to +105°C
 - Stockpile Temperature (储存温度): -20 °C to +40°C
 - transmission Speed: 8Gbps
- *出个别客户需要喷码, 详见客户包规及喷码管控表。

产品客户图 Customer Drw		GLGNET® 深圳市方向电子股份有限公司 SHEN ZHEN GLGNET ELECTRONICS CO.,LTD.					
未注公差 TOLERANCE UNLESS OTHERWISE SPECIFIED	.X ±0.20 .XX ±0.15 .XXX ±0.08 X° ±3°	设计 DESIGN	Qixiang Liu	2021/12/1	品名 TITLE	BTB M-SV-1-2x20-P080-H47-02	
比例 SCALE	1:1	角法 PROJ.	设计 CHECKED	Qixiang Liu	2021/12/1	料号 ITEM NO.	16005-02XXX1
张数 SHEET	1/1	大小 SIZE	核准 APPROVED	Shenghui He	2021/12/1	图号 DWG NO.	GLG-WS-543
单位 UNIT	mm	版本 REV.	A3				